



# Dish Cabinets

## Stainless Steel Shelving



Use your smart phone to scan the above QR code to visit our website:  
[www.bk-resources.com](http://www.bk-resources.com)

### Certifications:



### Features:

- 1 5/8" x 6" Adjustable S/S Leg
- 34 3/4" Overall Height
- Legs Adjust 1" in Height
- Fixed Intermediate Shelf

### Material:

- Heavy Gauge Stainless Steel Top
- 18 ga. Stainless Steel Body

Length	T-304 S/S 15" Width	Product Weight (lbs)	*Top Capacity	*Shelf Capacity	*Total Capacity	T-304 S/S 18" Width	Product Weight (lbs)	*Top Capacity	*Shelf Capacity	*Total Capacity
36"	BKDC-1536	85.00	1000	750	1000	BKDC-1836	93.00	1000	750	1000
48"	BKDC-1548	106.00	1000	300	1000	BKDC-1848	115.00	1000	300	1000
60"	BKDC-1560	127.00	940	150	1000	BKDC-1860	137.00	940	150	1000
72"	BKDC-1572	147.00	600	100	700	BKDC-1872	158.00	600	100	700

\* Weight must be evenly distributed

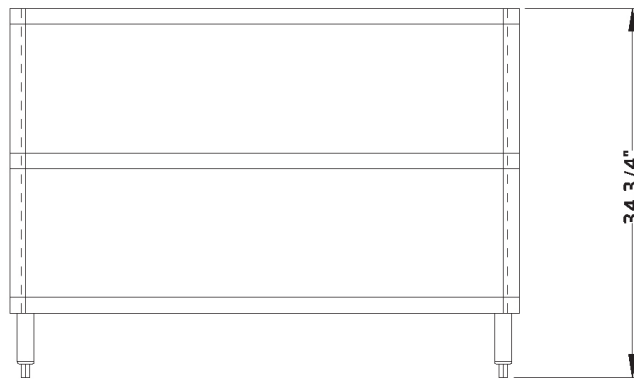
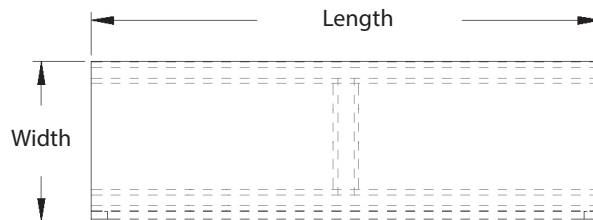

PRODUCT DATA SHEET

BK RESOURCES

