

Item #: _____	Qty #: _____
Model #: _____	
Project #: _____	

Sinks Include Faucet & Drain



DI-1-168
18 Gauge



DI-1-208
18 Gauge



DI-1-2012
16 Gauge



DI-1-30
20 Gauge

FEATURES:

One piece seamless **Deep Drawn** sink bowl design. All sink bowls have a large liberal radii with a minimum dimension of 2" and are rectangular in design for increased capacity.

Self-Rim Design. Mounting clips provided fit counters 7/8" to 2" thick. (Quantity supplied varies based on drop in sink ordered).

- DI-1-30 & DI-1-168:** includes 4" O.C. **K-52** faucet.
- DI-1-208 & DI-1-2012:** includes 4" O.C. **K-50** faucet.
- DI-1-2812:** includes 4" O.C. **K-53** faucet.

CONSTRUCTION:

Unit fabricated from one sheet of stainless steel. All bowls are Sound Deadened. Units feature Advance Tabco's **Smart Finish™**.

MECHANICAL:

Faucet supply is 1/2" IPS male thread. Deck mounted faucet is furnished with aerator. **Faucet Flow Rate:** 1.0 GPM/3.8 LPM aerator. 60 PSI.

MATERIAL:

Type 304 series stainless steel. Faucets are brass-nickel plated. Stainless Steel 1-1/2" IPS basket drain.

LARGEST ONE COMPARTMENT DROP-IN SINK IN THE INDUSTRY!

Supplied with **K-53 Faucet**

DI-1-2812
16 Gauge



Available Faucets & Accessories	Model #	Qty
Deck Mounted 8" Swing Spout. 4" O.C.	K-50	
Deck Mounted Gooseneck. 4" O.C.	K-52	
Deck Mounted. 12" Swing Spout. 4" O.C.	K-53	
Deck Mounted 8 1/2" Gooseneck. 4" O.C.	K-55	
Deck Mounted Swing w/Spray. 8" O.C.*	K-58	
Deck Mtd. X.H.D. 3 1/2" Gooseneck. 4" O.C.	K-62	
Mounting Clips (Bag of 4).	K-28	

*REQUIRES **K-472** FAUCET HOLE REVISION



STANDARD MOUNTING CLIPS

For countertops over 7/8" and up to 2" thick.
Replacement # K-28 (Per Sink)

WARNING: Faucets on this page may expose you to chemicals, including lead, that are known to the State of California to cause cancer or birth defects or other reproductive harm. For more Info., visit www.p65warnings.ca.gov.

DIMENSIONS and SPECIFICATIONS

TOL ± .125"

ALL DIMENSIONS ARE TYPICAL

DI-1-208 & DI-1-2012

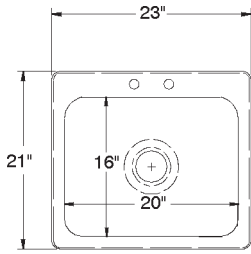

Cut-Out Size
22 1/4" x 20 1/4"
1 1/4" radius corners

DI-1-208

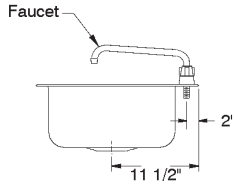
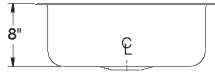

Approx. Wt. 18 lbs.

DI-1-2012

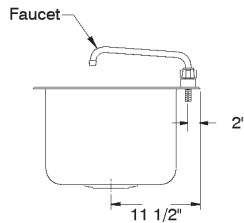
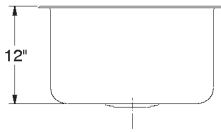

Approx. Wt. 20 lbs.

Supplied with K-50 Faucet

DI-1-168

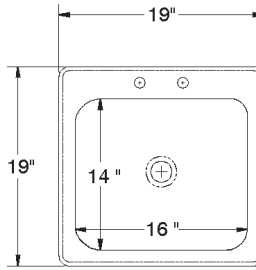

Cut-out Size
18 1/4" x 18 1/4"
1 1/4" radius corners

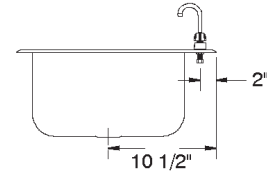
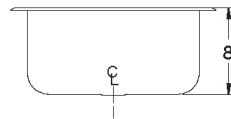

Supplied with K-52 Faucet

Approx. Wt. 15 lbs.

DI-1-2812

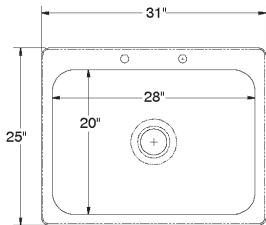

Cut-out Size
30 1/4" x 24 1/4"
1 1/4" radius corners

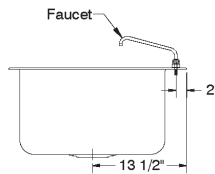
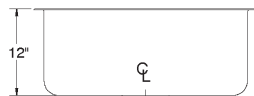

Approx. Wt. 42 lbs.

Supplied with K-53 Faucet

DI-1-30

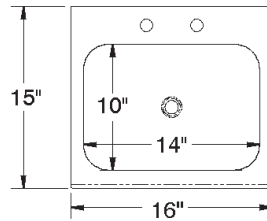

Cut-Out Size
15" x 14 1/4"
1 1/4" radius corners

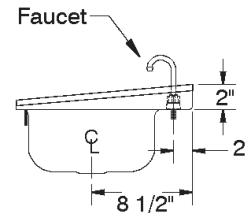
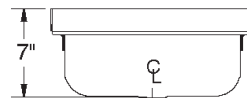

Supplied with K-52 Faucet

Approx. Wt. 11 lbs.

TYPICAL INSTALLATION

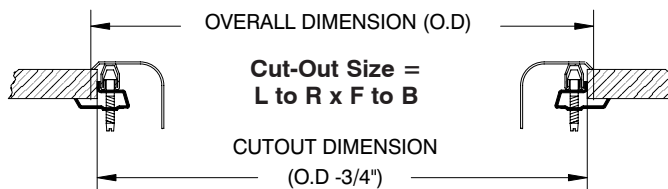

Standard Mounting Clips Fit Countertops
Over 7/8" & Up To 2" Thick.

