

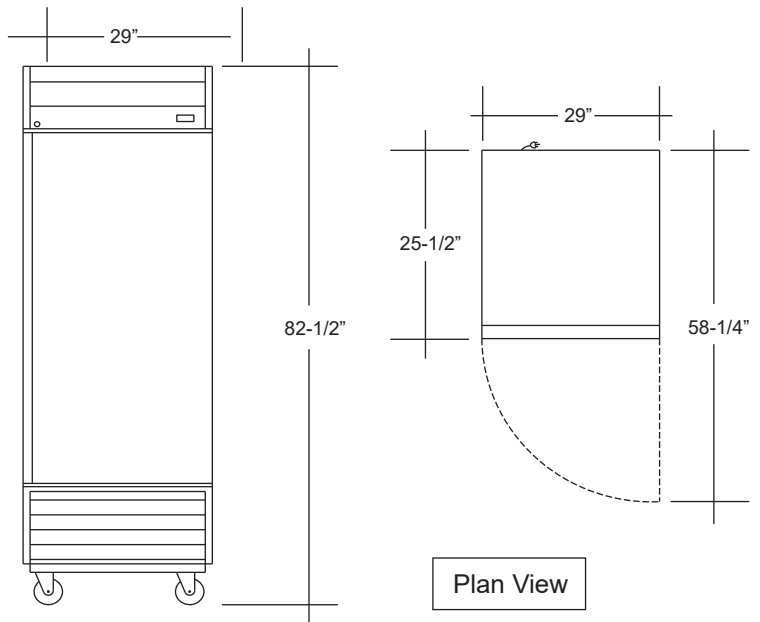

- **Stainless steel door and exterior sides, aluminum back. Bright white aluminum interior.**
- **Refrigeration system** keep food at safe temperatures.
- **Self -Closing door** with 90 degree stay-open feature. Locks and Keys included.
- **Shelves:** Adjustable heavy-duty PVC coated.
- **Pre-installed heavy duty casters with brakes.**
- **Electronic control system** makes it easy to adjust temperature set point and defrost frequency.
- **Removable installation board** makes it easy to access condenser coil for cleaning and service.
- **These units use HYDRO-CARBON R290 refrigerant,** which is environmentally friendly and more efficient than R134a/R404a refrigerant.

Economy Reach-In Refrigerator & Freezer ESRW Series



MODEL	TEMP	SHELVES	DIMENSIONS - WxDxH inches	CAPACITY cu.ft.	HP	AMPS	VOLTAGE	PLUG TYPE
ESRW-19R-HC	33°F- 41°F	3	29 x 25 3/8 x 82 1/2	19	1/5	2.8	115/60/1	NEMA 5-15P
ESRW-19F-HC	-8°F- 0°F	3	29 x 25 3/8 x 82 1/2	19	1/2+	8.28	115/60/1	NEMA 5-15P



Specifications subject to change without notice.

ENHANCED
REFRIGERATION

2610 E. Woodward Ave. Fresno, Ca. 93721
Email: customerservice@enhancedequipment.com
Phone (720) 309-1902

WARRANTY

5 Year Compressor
2 Year Parts and Labor